

# FENDER FLARE

## INSTALLATION INSTRUCTIONS

### IMPORTANT – READ BEFORE INSTALLATION

INSTALLATION SHOULD BE COMPLETED WHEN THE SURFACE TEMPERATURES OF YOUR SUBSTRATE ARE BETWEEN 60° TO 110° FAHRENHEIT (15° TO 43° C).

FENDER FLARE REQUIRES A 72 HOUR WETTING OUT PERIOD TO COME TO FULL ADHESION STRENGTH. SURFACE TEMPERATURES MUST REMAIN BETWEEN 60° TO 110° FAHRENHEIT (15° TO 43° C) DURING THAT TIME.

IT IS CRITICAL TO CLEAN AND PREPARE THE APPLICATION SURFACE PROPERLY TO REMOVE ALL CONTAMINATES, INCLUDING ANY DIRT OR OIL.

### CLEANING AND SURFACE PREPARATION

Trim-Lok recommends the use of a cleaning solution of ONE PART ISOPROPYL ALCOHOL and ONE PART WATER, a CLEAN RAG and the application of an ADHESIVE PROMOTER.



### FENDER FLARE

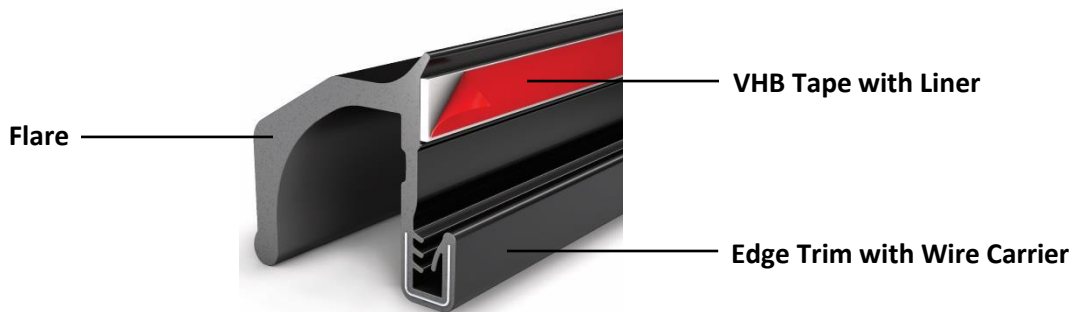

#### STEP 1

Spray the cleaning solution and wipe with clean rag.

DO NOT use a dirty rag.

#### STEP 1



#### STEP 2



Watch our How to Install Video at  
[www.fender-flare-install.info](http://www.fender-flare-install.info)

**TRIM-LOK.com**  
Questions? Call 888-TRIM-LOK

# FENDER FLARE

## INSTALLATION INSTRUCTIONS

(continued from Page 1)

### STEP 2

Measure 1" from the rim of the substrate.

Wear protective gloves and apply adhesive promoter and allow to dry thoroughly.

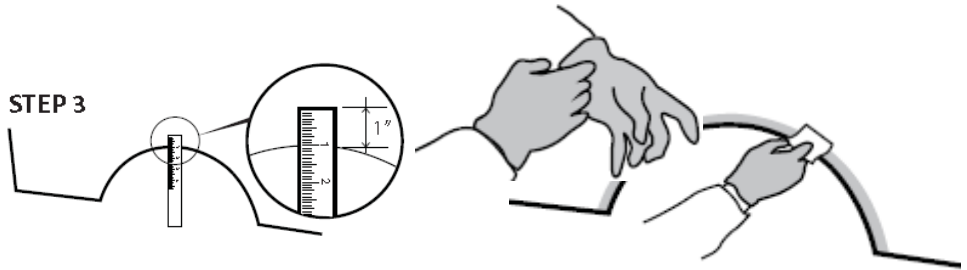

### STEP 3

Measure the substrate's radial length. If needed, cut the Fender Flare. Allow extra material on each end.

To cut through the Fender Flare use a pair of wire cutters or Straight Edge Clippers.

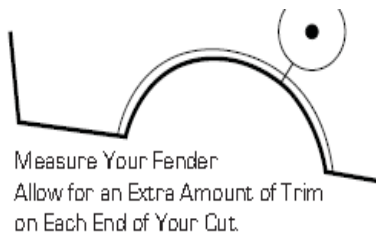

### STEP 7

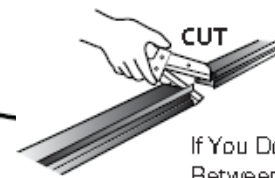

If You Don't Find the Space Between The Clips, It will Crush a Clip.

### STEP 4

Apply the Fender Flare onto the substrate. The Edge Trim should easily push into place.

DO NOT remove the peel-off liner.

Once the Fender Flare has been pushed on, use your hand, a rubber mallet or a pneumatic hammer to tap the Edge Trim to ensure the Fender Flare is completely pushed on.

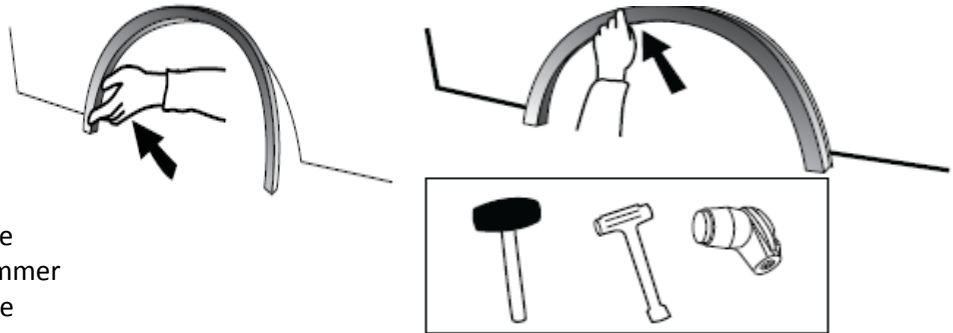

### STEP 5

Remove the tape liner in small sections. Use your hands to APPLY PRESSURE where the tape adheres to the substrate.

Repeat until the entire liner has been removed.

Any buckles in the Fender Flare can easily be manipulated into shape with your hands.

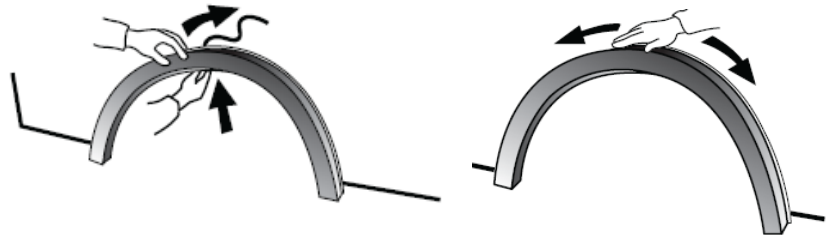

Watch our How to Install Video at  
[www.fender-flare-install.info](http://www.fender-flare-install.info)

**TRIM-LOK.com**

Questions? Call 888-TRIM-LOK